



FLEXIAGENT

Market Leading, Independent Estate Agents



Kempton Park Fold

Southport, PR8 5PL

Offers In Excess Of £250,000

Flexi Agent are delighted to present this three bedrooms detached property to the open market. Located walking distance from Kew retail park with a range of shops & amenities, bars cafes close by, as well as local schools & easy access via public transport into Southport town centre. Available for purchase with NO ONWARDS CHAIN.

The property briefly comprises of; entrance hall, WC, dining room with double doors to front bay window lounge, nicely presented kitchen, conservatory & utility room accessed from the rear.

The first floor briefly comprises of; three sizeable bedrooms with master featuring ensuite & family bathroom.

Externally the property offers to the front driveway parking, garage & low maintenance garden, to the rear offers a sun catching garden.

Viewings available upon request.

NO CHAIN
EPC C
Freehold
Council tax band D

Viewing

Please contact our Flexi Agent Southport Office on 01704 889455 if you wish to arrange a viewing appointment for this property or require further information.

- Three bedrooms
- Detached, circa 1314 sqft
- NO CHAIN
- Front bay window lounge
- Nicely presented kitchen
- Conservatory
- Family bathroom & ensuite
- Front driveway & garage
- Rear sun catching garden
- Viewings available upon request



Floor Plan

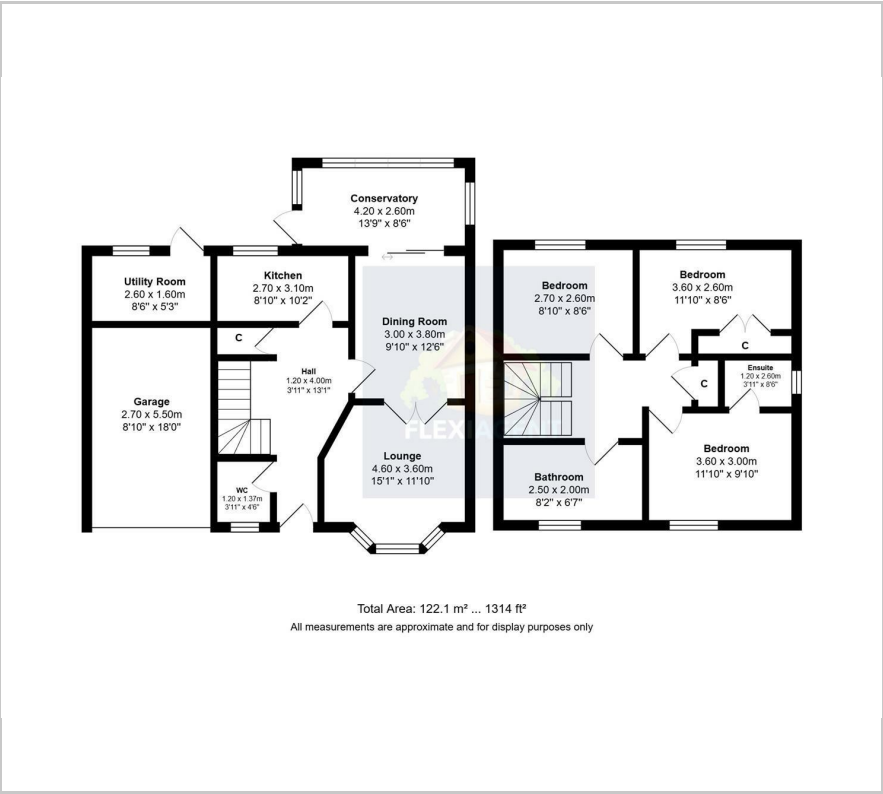

Area Map



Energy Efficiency Graph

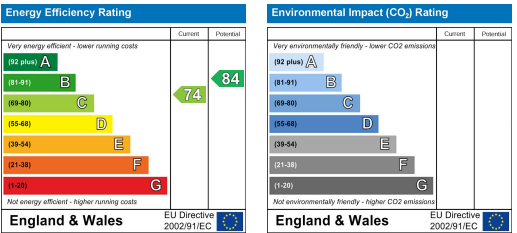

These particulars, whilst believed to be accurate are set out as a general outline only for guidance and do not constitute any part of an offer or contract. Intending purchasers should not rely on them as statements of representation of fact, but must satisfy themselves by inspection or otherwise as to their accuracy. No person in this firms employment has the authority to make or give any representation or warranty in respect of the property.